

American Samoa Department of Education Athletics Office Earthquake and Fire Evacuation Plan

EMERGENCY PROCEDURE

Step 1: Evacuate All Personnel from the Danger Area





Step 2: Proceed in an orderly manner to the Emergency Assembly Area

Step 3: Roll Call

IN CASE OF FIRE

- R - Rescue People
- A - Alert Emergency Services
- C - Confine Fire and Smoke
- E - Extinguish or Evacuate

LEGEND

-  EXIT PATH
-  EMERGENCY EXIT
-  EMERGENCY ROUTE 1
-  EMERGENCY ROUTE 2
-  ASSEMBLY AREA POINT

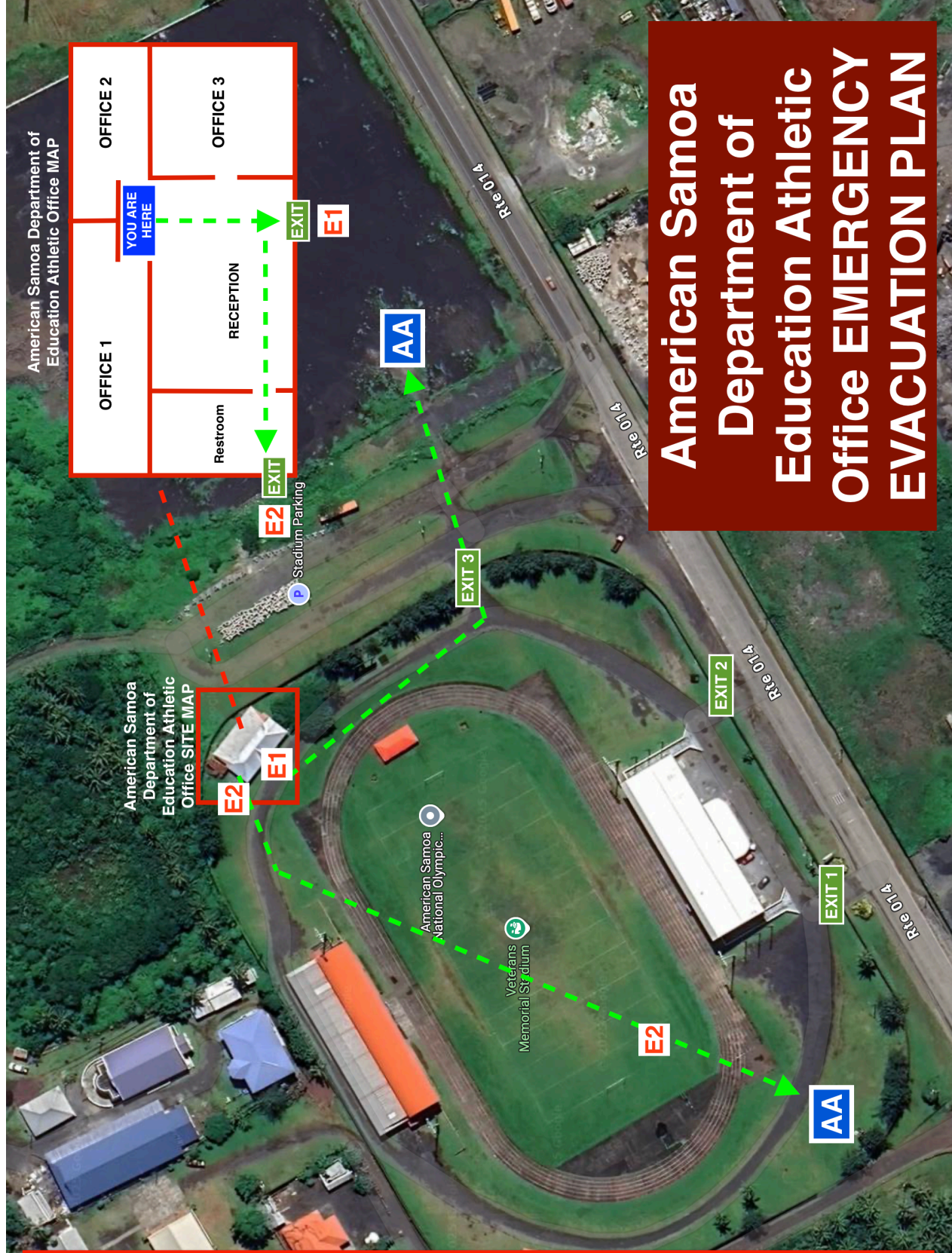

American Samoa Department of Education Athletics Office EMERGENCY EVACUATION PLAN